

ENCODER ASSOLUTO MONOGIRO / MULTIGIRO - ABSOLUTE SINGLE-TURN / MULTI-TURN ENCODER

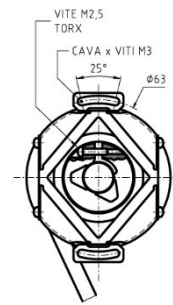
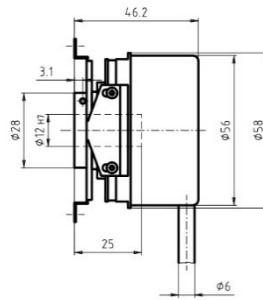
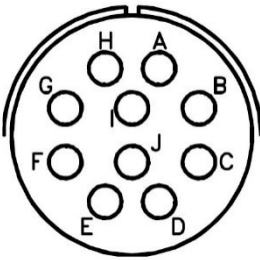

Modello – Model	ECN 413	EQN 425	ECN 425	EQN 437
Tipo – Type	ABSOLUTE - SINGLE TURN	ABSOLUTE - MULTI TURN	ABSOLUTE - SINGLE TURN	ABSOLUTE - MULTI TURN
Sicurezza – Safety	No	No	No	No
Risoluzione – Resolution available	512, 2048 SinCos		-	
Uscita – Output	SinCos 1 Vpp		-	
Segnali – Signals	Cos+, Cos-, Sin+, Sin-, Data+, Data-, Clock+, Clock-		Data+, Data-, Clock+, Clock-	
Alimentazione – Supply	3,6...14 Vdc			
Corrente senza carico – Current without load	< 85 mA (5V) Typical	< 105 mA (5V) Typical	< 85 mA (5V) Typical	105 mA (5V) Typical
Interfaccia – Interface	EnDat® 2.2 (EnDat 01)		EnDat® 2.2 (EnDat 22)	
Nr. di giri totali – Total nr. of turns	-	4096	-	4096
Nr. di posizioni per giro – Nr. of steps per revolution	8.192 (13 bit)		33.554.432 (25 bit)	
Nr. di posizioni totali – Total nr. of steps	-			
Frequenza max. – Max. frequency	512: 130 kHz; 2048: 400 kHz		-	
Velocità di esercizio – Operating speed	6000 rpm			
Temperatura di esercizio – Working temperature	-20...+100 °C			
Custodia e albero – Housing and shaft	d.58 mm, hollow shaft d.12 mm			
Grado di protezione – Protection degree	IP 64			
Connettore standard – Standard connector	Size 20 - 14 pin		Size 18 – 10 pin / Size 20 - 14 pin	
Cavo – Cable	1 m			
Peso – Weight	0,3 kg			
Inerzia – Inertia	43 gcm ²			
Resistenza agli urti – Res. to shocks (IEC 60068-2-27)	< 200 g (6 ms)			
Resistenza alle vibrazioni – Res. to vibrations (IEC 60068-2-6)	< 30 g (55...2000 Hz)			
Note:	-			

Size 18 - 10 pin - ECN425 / EQN437

CONNETTORE - CONNECTOR	PIN	SEGNALE - SIGNAL	COLORE - COLOR
	A	-	-
	B	-	-
	C	DATA+	Grigio - Grey
	D	-	-
	E	SHIELD	Schermo - Shield
	F	DATA-	Rosa - Pink
	G	CLOCK+	Viola - Purple
	H	CLOCK-	Giallo - Yellow
	I	+VDC	Marrone/Verde + Blu - Brown/Green + Blue
	J	0V (GND)	Bianco/Verde + Bianco - White/Green + White

Size 20 - 14 pin - ECN413 / EQN425 / ECN425 / EQN437

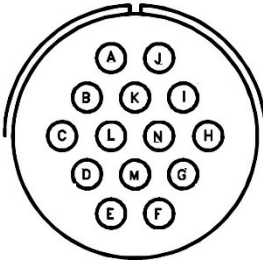
CONNETTORE - CONNECTOR	PIN	SEGNALE - SIGNAL		COLORE - COLOR
		ECN413/EQN425	ECN425/EQN437	
	A	COS+	-	Verde/Nero - Green/Black
	B	SIN+	-	Blu/Nero - Blue/Black
	C	DATA+	DATA+	Grigio - Grey
	D	COS-	-	Giallo/Nero - Yellow/Black
	E	SIN-	-	Rosso/Nero - Red/Black
	F	DATA-	DATA-	Rosa - Pink
	G	CLOCK+	CLOCK+	Viola - Purple
	H	CLOCK-	CLOCK-	Giallo - Yellow
	I	+VDC	+VDC	Marrone/Verde + Blu - Brown/Green + Blue
	J	0V (GND)	0V (GND)	Bianco/Verde + Bianco - White/Green + White
	K	SHIELD	SHIELD	Schermo - Shield
	L	-	-	-
	M	-	-	-
	N	-	-	-

Technical data and drawings are subject to change without notice.